

- ### LEGEND
- Title boundary / cadastre
  - Pre development contours at 200mm intervals
  - Extent of works
  - Existing speed limit
  - Tree to be protected & retained
  - Existing footpath
  - Veranda / undercover area
  - Existing grass swale
  - Ballarat - Skipton rail trail
  - OHE- Existing overhead power line & power pole
  - ✗ Tree to be removed
  - Item to be removed / demolished
  - Existing driveway crossover
  - Proposed driveway
  - Proposed asphalt surface
  - Proposed feature pavement
  - Proposed concrete footpath / surface
  - Future footpath - refer to G.P.S. footpath strategy
  - Grass naturestrip
  - Proposed garden bed
  - Proposed gravel mulch
  - Proposed kerb
  - Proposed car park
  - Proposed long vehicle park
  - Proposed accessible angle parking flush with footpath
  - Proposed shared area flush with footpath
  - Proposed large canopy tree
  - Proposed medium tree
  - Proposed small tree
  - Proposed banner pole / art work location
  - Proposed wombat crossing
  - Proposed arbor
  - Proposed picnic table
  - Bus stop
  - ★ Bus stop upgrade
  - ★ Proposed outdoor dining area
  - ★ Proposed EV charging station
  - Proposed furniture node

DRAFT

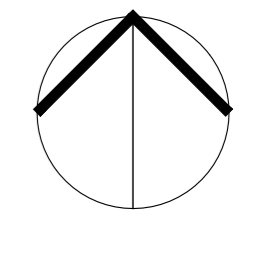

**Project Name & Address:**  
Northern Streetscapes  
SMYTHESDALE

**Drawing Title:**  
Overall Concept Plan & Planting Palette

**Client:**  
Golden Plains Shire Council

**Date:** November 21, 2024  
**Scale:** 1:750 @ A1 Sheet Size

**Drawn:** OJ  
**Checked:** HM  
**Drawing No:** 2433 - LP01

**Revision:**

**THOMSON HAY**  
LANDSCAPE ARCHITECTS

Base information derived from the following sources:  
 - Feature and level survey by LandSurveys  
 - Nearmap aerial (April 23, 2024)  
 - GIS data sourced from open source data  
 - Supermarket plans by TRG

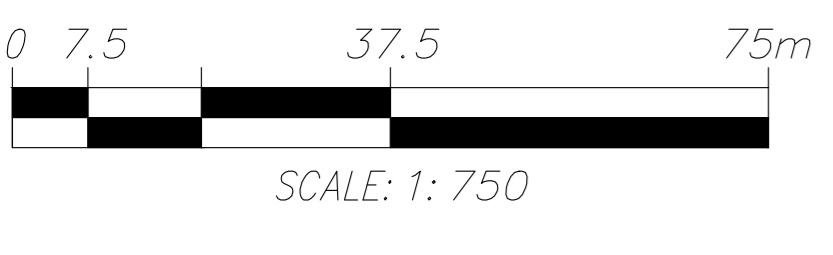

## Smythesdale Plant Palette

Botanical Name	Common Name	Mature H x W
<b>Existing Trees</b>		
<i>Acer negundo</i>	Box Elder	
<i>Quercus sp.</i>	Oak	
<b>Proposed Large Canopy Trees</b>		
<i>Angophora floribunda</i>	Rough-barked Apple Gum	12 x 10m
<i>Platanus x acerifolia</i>	London Plane	14 x 10m
<i>Quercus ilex</i>	Evergreen Oak	15 x 8m
<i>Quercus palustris</i> 'Free Fall'	Pin Oak (early defoliating)	15 x 8m
<b>Proposed Medium Trees</b>		
<i>Acer campestre</i> 'Elsrijk'	Compact Feid Maple	7 x 6m
<i>Acer negundo</i> 'Sensation'	Box Elder	9 x 6m
<i>Carpinus betulus</i> 'Frans Fontaine'	Hornbeam ctv.	10 x 5m
<i>Quercus palustris</i> 'Pringreen'	Upright Pin Oak	14 x 3m
<b>Proposed Small Trees (suitable under powerlines)</b>		
<i>Callistemon</i> 'Harkness'	Bottlebrush ctv.	5 x 3m
<i>Callistemon</i> 'Kings Park Special'	Bottlebrush ctv.	4 x 3m
<i>Cercis siliquastrum</i>	Judas Tree	6 x 4m
<i>Lagerstroemia indica x fauriei</i> 'Natchez'	Crepe Myrtle (white)	6 x 4m
<b>Proposed Shrubs and Groundcovers</b>		
<i>Chrysocephalum apiculatum</i>	Common Everlasting	0.3 x 0.5m
<i>Correa pulchella</i> 'Fire Bells'	Correa ctv.	0.3 x 0.8m
<i>Correa reflexa prostrate</i>	Prostrate Correa	0.3 x 1m
<i>Grevillea juniperina</i> 'Molonglo'	Grevillea ctv.	0.5 x 2m
<i>Ozothamanus obcordatus</i>	Grey Everlasting	0.6 x 0.5m
<i>Westringia</i> 'Low Horizon'	Coast Rosemary ctv.	0.3 x 0.7m
<b>Proposed Bladed Plants and Grasses</b>		
<i>Dianella revoluta</i> 'Little Rev'	Dianella ctv.	0.4 x 0.4m
<i>Dianella tasmanica</i> 'Emerald Arch'	Dianella ctv.	0.5 x 0.5m
<i>Dianella tasmanica</i> 'Tasred'	Dianella ctv.	0.6 x 0.6m
<i>Lomandra</i> 'Tanika'	Lomandra ctv.	0.6 x 0.6m



**LEGEND**

	Title boundary / cadastre
	Pre development contours at 200mm intervals
	Existing speed limit
	Tree to be protected & retained
	Existing footpath
	Veranda / undercover area
	Existing grass swale
	Existing overhead power line & power pole
	Tree to be removed
	Item to be removed / demolished
	Existing driveway crossover
	Proposed driveway
	Proposed feature pavement
	Proposed concrete footpath / surface
	Grass naturestrip
	Proposed garden bed
	Proposed kerb
	Proposed accessible angle parking flush with footpath
	Proposed shared area flush with footpath
	Proposed large canopy tree
	Proposed medium tree
	Proposed small tree
	Proposed banner pole / art work location
	Proposed wombat crossing
	Proposed outdoor dining area
	Proposed EV charging station
	Proposed furniture node

**DRAFT**

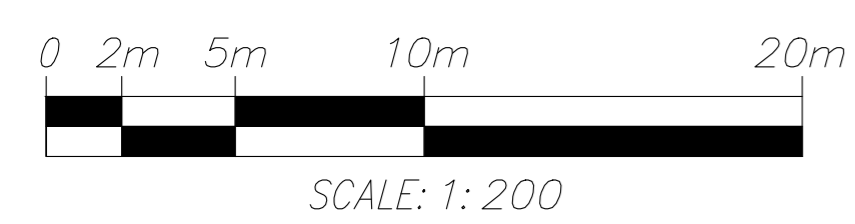
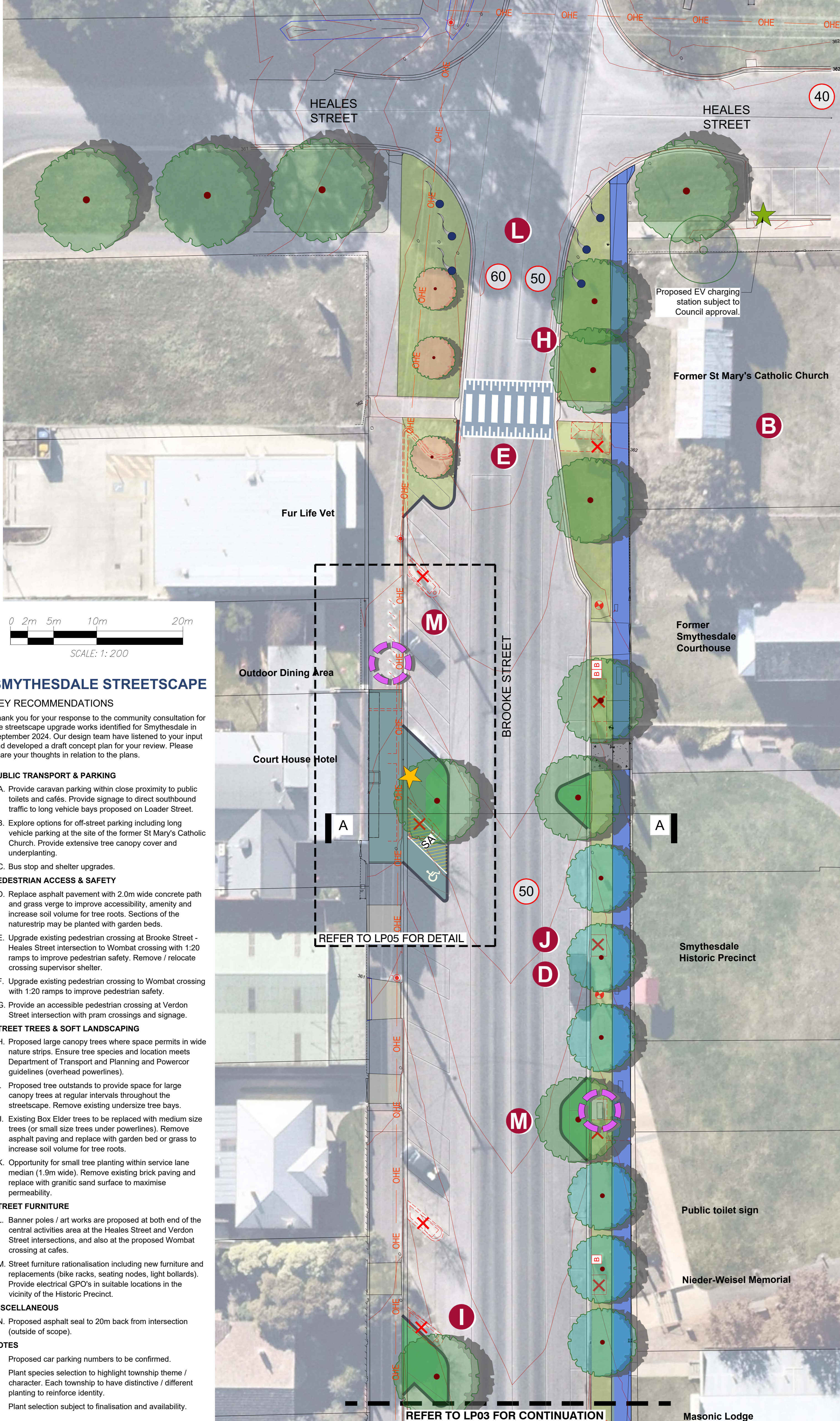

**SMYTHESDALE STREETScape**

**KEY RECOMMENDATIONS**

Thank you for your response to the community consultation for the streetscape upgrade works identified for Smythesdale in September 2024. Our design team have listened to your input and developed a draft concept plan for your review. Please share your thoughts in relation to the plans.

**PUBLIC TRANSPORT & PARKING**

- A. Provide caravan parking within close proximity to public toilets and cafés. Provide signage to direct southbound traffic to long vehicle bays proposed on Loader Street.
- B. Explore options for off-street parking including long vehicle parking at the site of the former St Mary's Catholic Church. Provide extensive tree canopy cover and underplanting.
- C. Bus stop and shelter upgrades.

**PEDESTRIAN ACCESS & SAFETY**

- D. Replace asphalt pavement with 2.0m wide concrete path and grass verge to improve accessibility, amenity and increase soil volume for tree roots. Sections of the naturestrip may be planted with garden beds.
- E. Upgrade existing pedestrian crossing at Brooke Street - Heales Street intersection to Wombat crossing with 1:20 ramps to improve pedestrian safety. Remove / relocate crossing supervisor shelter.
- F. Upgrade existing pedestrian crossing to Wombat crossing with 1:20 ramps to improve pedestrian safety.
- G. Provide an accessible pedestrian crossing at Verdon Street intersection with pram crossings and signage.

**STREET TREES & SOFT LANDSCAPING**

- H. Proposed large canopy trees where space permits in wide nature strips. Ensure tree species and location meets Department of Transport and Planning and Powercor guidelines (overhead powerlines).
- I. Proposed tree outstands to provide space for large canopy trees at regular intervals throughout the streetscape. Remove existing undersize tree bays.
- J. Existing Box Elder trees to be replaced with medium size trees (or small size trees under powerlines). Remove asphalt paving and replace with garden bed or grass to increase soil volume for tree roots.
- K. Opportunity for small tree planting within service lane median (1.9m wide). Remove existing brick paving and replace with granitic sand surface to maximise permeability.

**STREET FURNITURE**

- L. Banner poles / art works are proposed at both end of the central activities area at the Heales Street and Verdon Street intersections, and also at the proposed Wombat crossing at cafes.
- M. Street furniture rationalisation including new furniture and replacements (bike racks, seating nodes, light bollards). Provide electrical GPO's in suitable locations in the vicinity of the Historic Precinct.

**MISCELLANEOUS**

- N. Proposed asphalt seal to 20m back from intersection (outside of scope).

**NOTES**

- Proposed car parking numbers to be confirmed.
- Plant species selection to highlight township theme / character. Each township to have distinctive / different planting to reinforce identity.
- Plant selection subject to finalisation and availability.

REFER TO LP05 FOR DETAIL

REFER TO LP03 FOR CONTINUATION

Proposed EV charging station subject to Council approval.

**Project Name & Address:**  
Northern Streetscapes  
SMYTHESDALE

**Drawing Title:**  
Streetscape Concept Plan  
- Sheet 1

**Client:**  
Golden Plains Shire Council

**Date:** November 21, 2024  
**Scale:** 1:200 @ A1 Sheet Size  
**Drawn:** OJ  
**Checked:** HM  
**Drawing No:** 2433 - LP02  
**Revision:**

**THOMSON HAY**  
LANDSCAPE ARCHITECTS

130 Howards Rd, Wattle Flat VIC 3352  
T 03 5334 5321 W www.thomsonhay.com



# SMYTHESDALE STREETSCAPE

## KEY RECOMMENDATIONS

Thank you for your response to the community consultation for the streetscape upgrade works identified for Smythesdale in September 2024. Our design team have listened to your input and developed a draft concept plan for your review. Please share your thoughts in relation to the plans.

## PUBLIC TRANSPORT & PARKING

- A. Provide caravan parking within close proximity to public toilets and cafés. Provide signage to direct southbound traffic to long vehicle bays proposed on Loader Street.
- B. Explore options for off-street parking including long vehicle parking at the site of the former St Mary's Catholic Church. Provide extensive tree canopy cover and underplanting.
- C. Bus stop and shelter upgrades.

## PEDESTRIAN ACCESS & SAFETY

- D. Replace asphalt pavement with 2.0m wide concrete path and grass verge to improve accessibility, amenity and increase soil volume for tree roots. Sections of the naturestrip may be planted with garden beds.
- E. Upgrade existing pedestrian crossing at Brooke Street - Heales Street intersection to Wombat crossing with 1:20 ramps to improve pedestrian safety. Remove / relocate crossing supervisor shelter.
- F. Upgrade existing pedestrian crossing to Wombat crossing with 1:20 ramps to improve pedestrian safety.
- G. Provide an accessible pedestrian crossing at Verdon Street intersection with pram crossings and signage.

## STREET TREES & SOFT LANDSCAPING

- H. Proposed large canopy trees where space permits in wide nature strips. Ensure tree species and location meets Department of Transport and Planning and Powercor guidelines (overhead powerlines).
- I. Proposed tree outstands to provide space for large canopy trees at regular intervals throughout the streetscape. Remove existing undersize tree bays.
- J. Existing Box Elder trees to be replaced with medium size trees (or small size trees under powerlines). Remove asphalt paving and replace with garden bed or grass to increase soil volume for tree roots.
- K. Opportunity for small tree planting within service lane median (1.9m wide). Remove existing brick paving and replace with granitic sand surface to maximise permeability.

## STREET FURNITURE

- L. Banner poles / art works are proposed at both end of the central activities area at the Heales Street and Verdon Street intersections, and also at the proposed Wombat crossing at cafes.
- M. Street furniture rationalisation including new furniture and replacements (bike racks, seating nodes, light bollards). Provide electrical GPO's in suitable locations in the vicinity of the Historic Precinct.

## MISCELLANEOUS

- N. Proposed asphalt seal to 20m back from intersection (outside of scope).

## NOTES

- Proposed car parking numbers to be confirmed.
- Plant species selection to highlight township theme / character. Each township to have distinctive / different planting to reinforce identity.
- Plant selection subject to finalisation and availability.

REFER TO LP02 FOR CONTINUATION

Masonic Lodge

Smythesdale Historic Post Office

LOADER STREET

LOADER STREET

BROOKE STREET

Ballarat Country Vets

Smythesdale Farm Supplies

Ruth Howlett Collectables

Rustic Edge Cafe

Thru the Gate Cafe

REFER TO LP05 FOR DETAIL

REFER TO LP04 FOR CONTINUATION

REVISIONS

21.11.24 Draft for council and community review

## LEGEND

- Title boundary / cadastre
- Pre development contours at 200mm intervals
- Tree to be protected & retained
- Existing footpath
- Veranda / undercover area
- Existing overhead power line & power pole
- Tree to be removed
- Item to be removed / demolished
- Existing driveway crossover
- Proposed feature pavement
- Proposed concrete footpath / surface
- Future footpath - refer to G.P.S. footpath strategy
- Grass naturestrip
- Proposed garden bed
- Proposed kerb
- Proposed long vehicle park
- Proposed large canopy tree
- Proposed medium tree
- Proposed small tree
- Proposed banner pole / art work location
- Proposed wombat crossing
- Bus stop
- Bus stop upgrade
- Proposed outdoor dining area
- Proposed furniture node

DRAFT

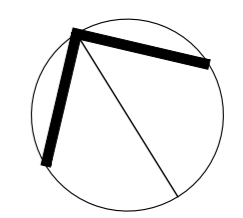

0 2m 5m 10m 20m

SCALE: 1:200

Project Name & Address:  
Northern Streetscapes  
SMYTHESDALE

Drawing Title:  
Streetscape Concept Plan  
- Sheet 2

Client:  
Golden Plains Shire Council

Date: November 21, 2024

Scale: 1:200 @ A1 Sheet Size

Drawn: OJ

Checked: HM

Drawing No: 2433 - LP03

Revision:

THOMSON HAY  
LANDSCAPE ARCHITECTS

130 Howards Rd, Wattle Flat VIC 3352  
T 03 5334 5321 W www.thomsonhay.com



# SMYTHESDALE STREETScape

## KEY RECOMMENDATIONS

Thank you for your response to the community consultation for the streetscape upgrade works identified for Smythesdale in September 2024. Our design team have listened to your input and developed a draft concept plan for your review. Please share your thoughts in relation to the plans.

## PUBLIC TRANSPORT & PARKING

- A. Provide caravan parking within close proximity to public toilets and cafés. Provide signage to direct southbound traffic to long vehicle bays proposed on Loader Street.
- B. Explore options for off-street parking including long vehicle parking at the site of the former St Mary's Catholic Church. Provide extensive tree canopy cover and underplanting.
- C. Bus stop and shelter upgrades.

## PEDESTRIAN ACCESS & SAFETY

- D. Replace asphalt pavement with 2.0m wide concrete path and grass verge to improve accessibility, amenity and increase soil volume for tree roots. Sections of the naturestrip may be planted with garden beds.
- E. Upgrade existing pedestrian crossing at Brooke Street - Heales Street intersection to Wombat crossing with 1:20 ramps to improve pedestrian safety. Remove / relocate crossing supervisor shelter.
- F. Upgrade existing pedestrian crossing to Wombat crossing with 1:20 ramps to improve pedestrian safety.
- G. Provide an accessible pedestrian crossing at Verdon Street intersection with pram crossings and signage.

## STREET TREES & SOFT LANDSCAPING

- H. Proposed large canopy trees where space permits in wide nature strips. Ensure tree species and location meets Department of Transport and Planning and Powercor guidelines (overhead powerlines).
- I. Proposed tree outstands to provide space for large canopy trees at regular intervals throughout the streetscape. Remove existing undersize tree bays.
- J. Existing Box Elder trees to be replaced with medium size trees (or small size trees under powerlines). Remove asphalt paving and replace with garden bed or grass to increase soil volume for tree roots.
- K. Opportunity for small tree planting within service lane median (1.9m wide). Remove existing brick paving and replace with granitic sand surface to maximise permeability.

## STREET FURNITURE

- L. Banner poles / art works are proposed at both end of the central activities area at the Heales Street and Verdon Street intersections, and also at the proposed Wombat crossing at cafes.
- M. Street furniture rationalisation including new furniture and replacements (bike racks, seating nodes, light bollards). Provide electrical GPO's in suitable locations in the vicinity of the Historic Precinct.

## MISCELLANEOUS

- N. Proposed asphalt seal to 20m back from intersection (outside of scope).

## NOTES

- Proposed car parking numbers to be confirmed.
- Plant species selection to highlight township theme / character. Each township to have distinctive / different planting to reinforce identity.
- Plant selection subject to finalisation and availability.

## LEGEND

- Title boundary / cadastre
- Pre development contours at 200mm intervals
- Existing speed limit
- Tree to be protected & retained
- Existing footpath
- Veranda / undercover area
- Existing overhead power line & power pole
- Tree to be removed
- Item to be removed / demolished
- Existing driveway crossover
- Proposed driveway
- Proposed asphalt surface
- Proposed feature pavement
- Proposed concrete footpath / surface
- Grass naturestrip
- Proposed garden bed
- Proposed gravel mulch
- Proposed kerb
- Proposed long vehicle park
- Proposed car park
- Proposed large canopy tree
- Proposed medium tree
- Proposed small tree
- Proposed banner pole / art work location
- Proposed arbor
- Proposed picnic table
- Proposed furniture node

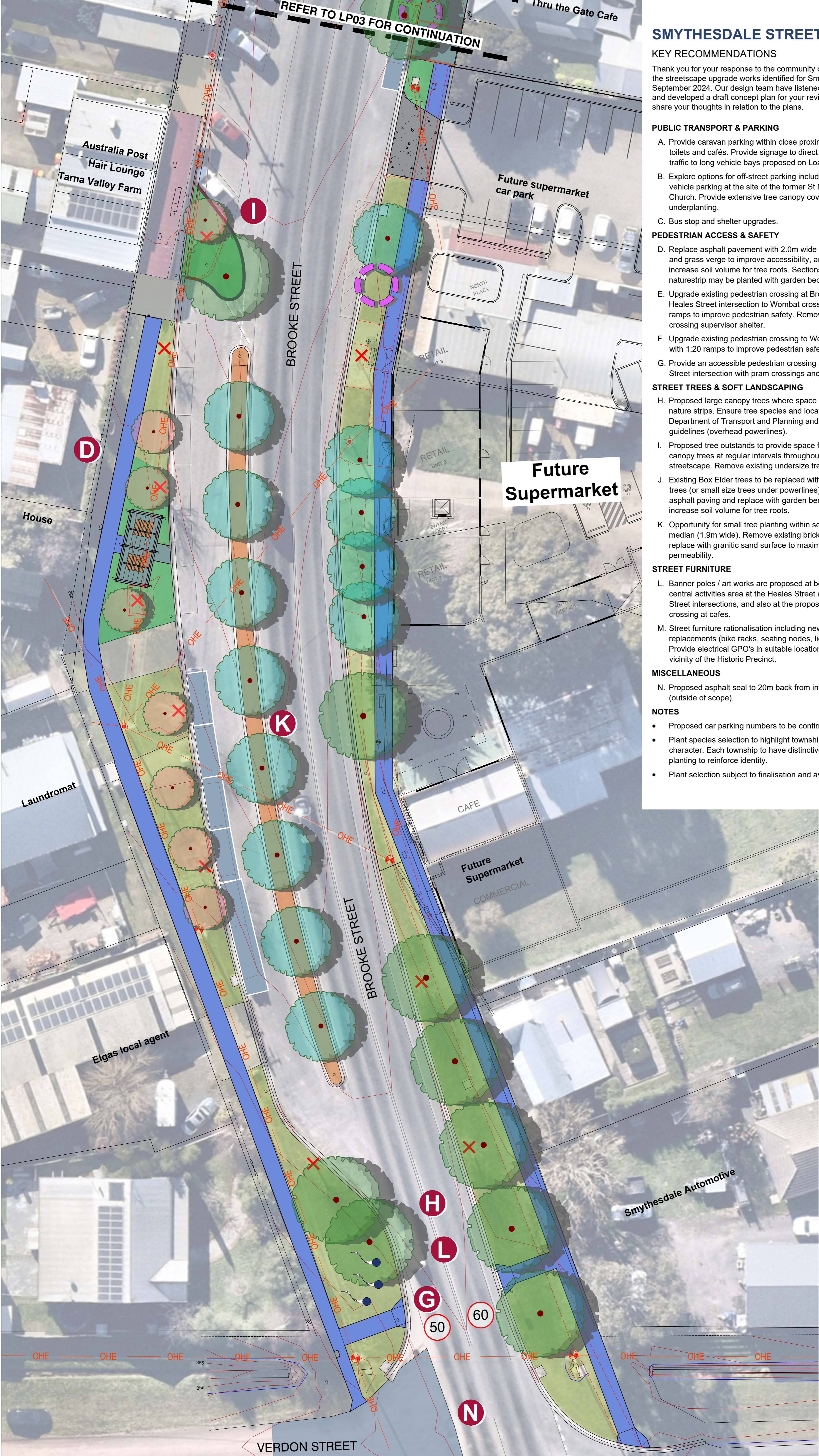

**DRAFT**

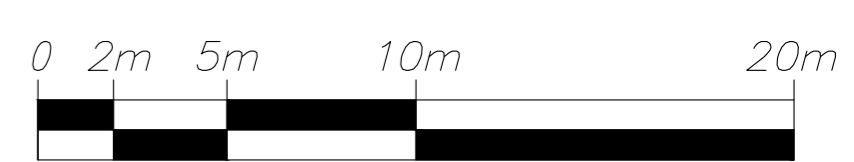
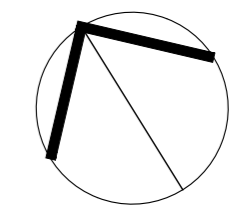

SCALE: 1:200

Project Name & Address:  
**Northern Streetscapes  
SMYTHESDALE**

Drawing Title:  
**Streetscape Concept Plan  
- Sheet 3**

Client:  
**Golden Plains Shire Council**

Date: November 21, 2024  
Scale: 1:200 @ A1 Sheet Size

Drawn: OJ  
Checked: HM

Drawing No: 2433 - LP04  
Revision:

**THOMSON HAY**  
LANDSCAPE ARCHITECTS



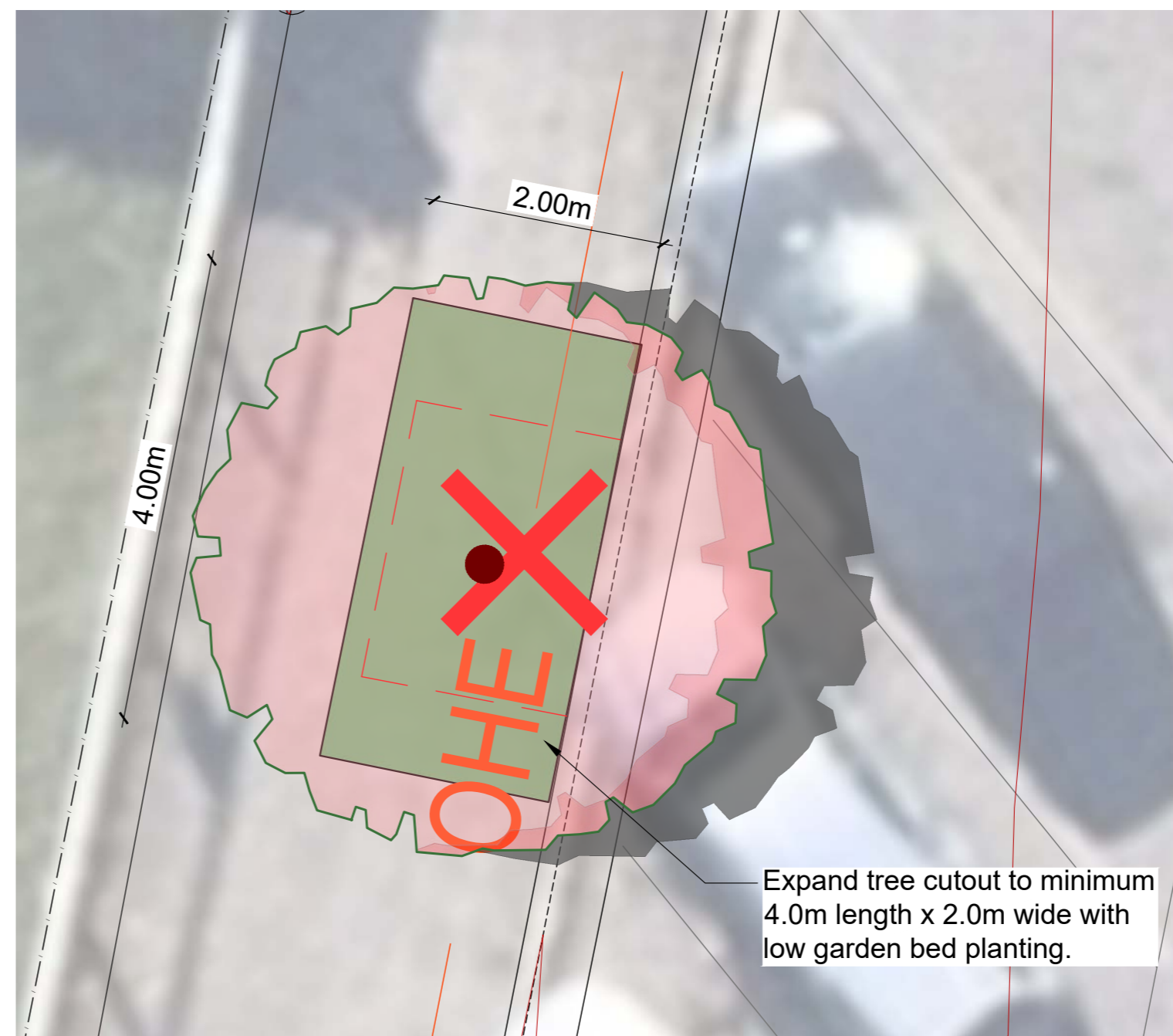
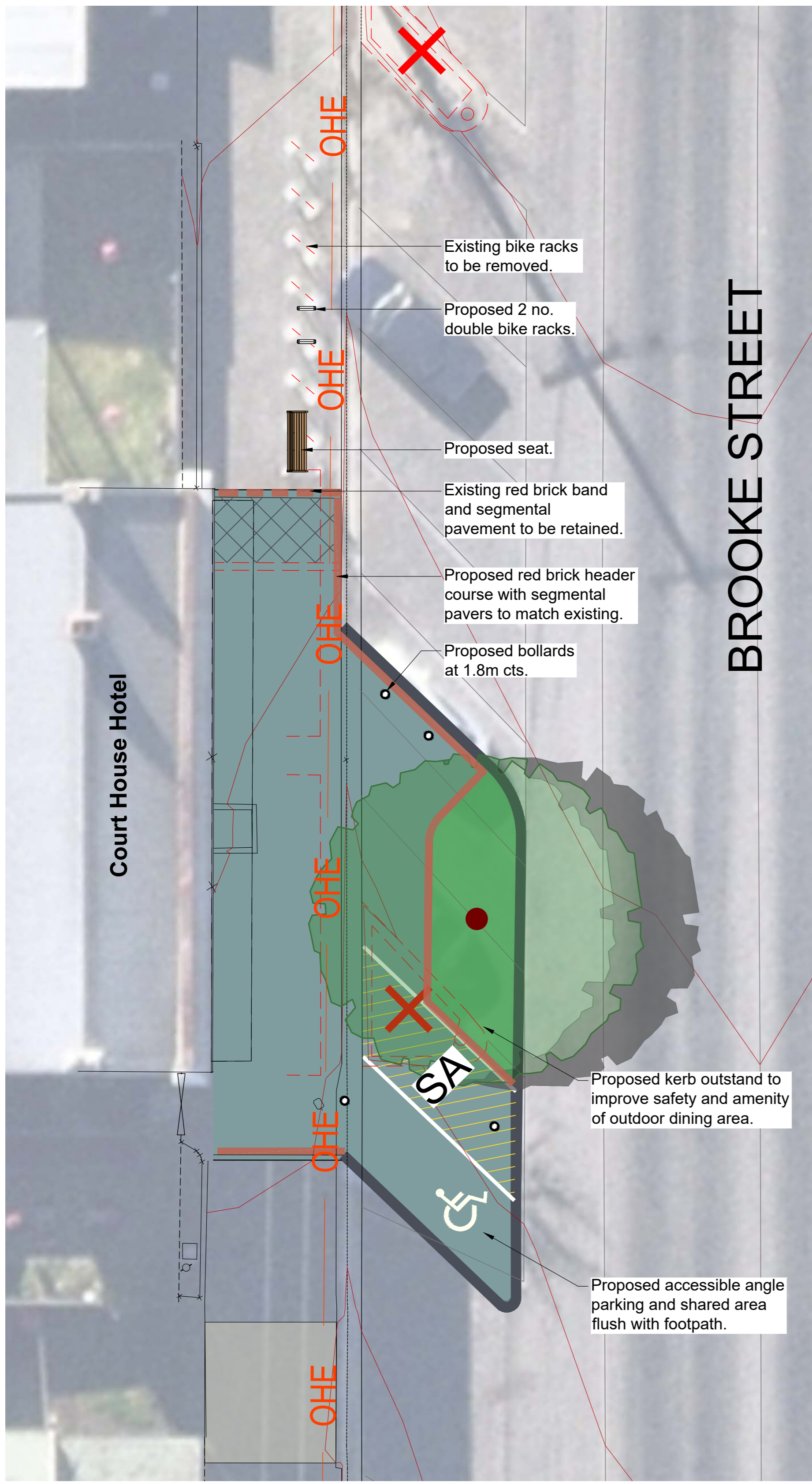

**TREE CUT OUT TYPICAL DETAIL PLAN**  
Scale 1:50 @ A1

**LEGEND**

- Title boundary / cadastre
- Pre development contours at 200mm intervals
- Existing footpath
- Veranda / undercover area
- Existing overhead power line & power pole
- Item to be removed / demolished
- Existing driveway crossover
- Existing segmental pavement
- Proposed segmental pavement
- Red brick banding to be retained
- Proposed red brick banding
- Proposed garden bed
- Proposed kerb
- Proposed accessible angle parking flush with footpath
- Proposed shared area flush with footpath
- Proposed wombat crossing
- Proposed large canopy tree
- Proposed banner pole / art work location
- Proposed seat
- Proposed bike rack
- Proposed bollard
- Proposed bin location

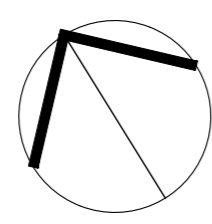
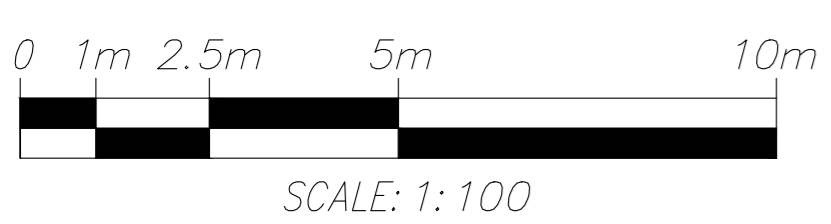

**DRAFT**

**Project Name & Address:**  
Northern Streetscapes  
SMYTHESDALE

**Drawing Title:**  
Streetscape Detail  
Concept Plans

**Client:**  
Golden Plains Shire Council

**Date:** November 21, 2024

**Scale:** As Shown @ A1 Sheet Size

**Drawn:** OJ

**Checked:** HM

**Drawing No:** 2433 - LP05

**Revision:**

**THOMSON HAY**  
LANDSCAPE ARCHITECTS



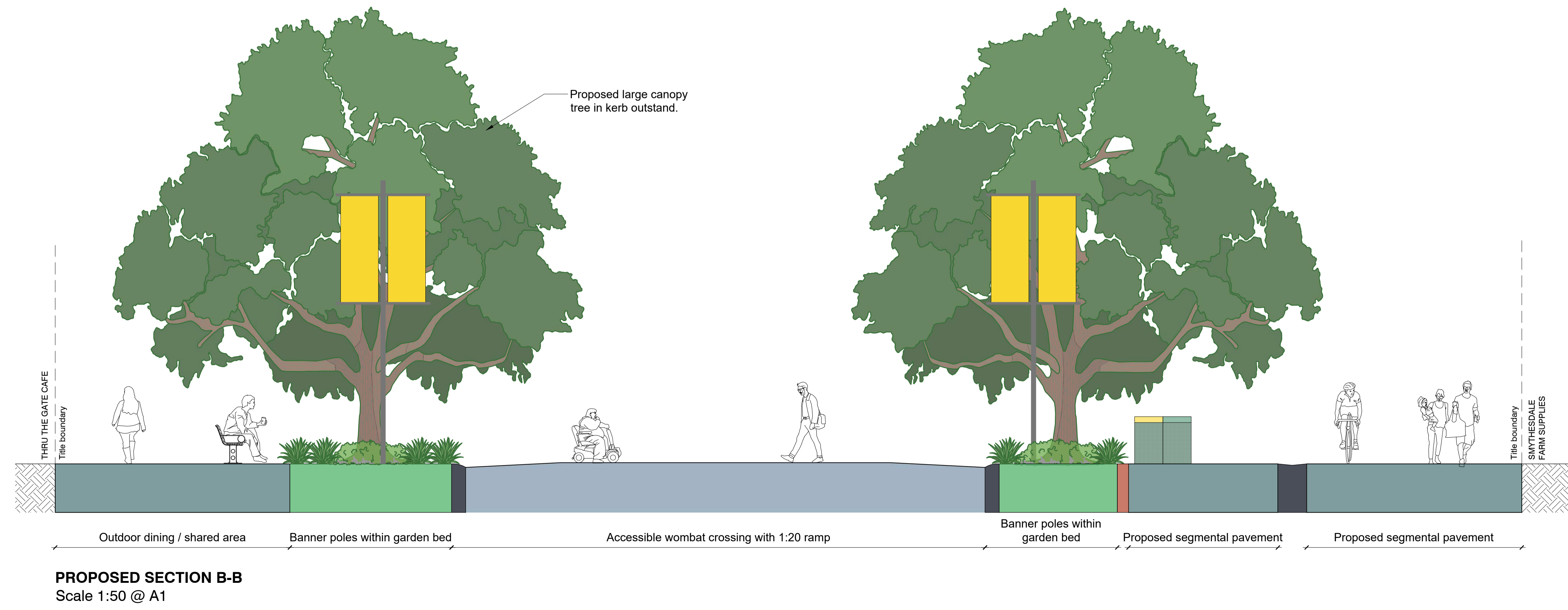

DRAFT

Project Name & Address:  
**Northern Streetscapes  
SMYTHESDALE**

Drawing Title:  
**Concept Sections**

Client:  
**Golden Plains Shire Council**

Date: November 21, 2024  
Scale: 1:50 @ A1 Sheet Size

Drawn: OJ  
Checked: HM  
Drawing No: 2433 - LP06

Revision:

**THOMSON HAY**  
LANDSCAPE ARCHITECTS