

Scarsdale Plant Palette

Botanical Name	Common Name	Mature H x W
Existing Trees		
<i>Pittosporum</i> sp.	Pittosporum	
<i>Ulmus</i> sp.	Elm	
Proposed Large Canopy Trees		
<i>Eucalyptus leucoxylon</i> 'Rosea'	Red-flowering Yellow Gum	14 x 7m
<i>Eucalyptus rubida</i>	Candlebark	16 x 12m
<i>Ulmus</i> 'Sapporo Autumn Gold'	Sapporo Autumn Gold Elm	15 x 10m
Oak or Elm to match Avenue of Honour		
Proposed Small Trees (suitable under powerlines)		
<i>Callistemon</i> 'Kings Park Special'	Bottlebrush ctv.	4 x 3m
Proposed Shrubs and Groundcovers		
<i>Banksia spinulosa</i> 'Bush Candles'	Hairpin Banksia ctv.	0.5 x 1.5m
<i>Correa alba</i>	White Correa	1.2 x 1.2m
<i>Myoporum parvifolium</i>	Creeping Boobialla (Fine Leaf Form)	0.3 x 1m
<i>Rhaphiolepis</i> 'Cosmic Pink'	Indian Hawthorn ctv.	0.6 x 0.6m
<i>Rhaphiolepis</i> 'Snow Maiden'	Indian Hawthorn ctv.	1 x 1m
<i>Westringia</i> 'Mundi'	Coast Rosemary ctv.	0.4 x 1m
Proposed Bladed Plants and Grasses		
<i>Dianella revoluta</i> 'Little Rev'	Dianella ctv.	0.4 x 0.4m
<i>Dianella tasmanica</i> 'Tasred'	Dianella ctv.	0.6 x 0.6m
<i>Lomandra</i> 'Tanika'	Lomandra ctv.	0.6 x 0.6m
<i>Poa labillardierei</i>	Common Tussock-grass	1 x 0.5m



REVISIONS
 21.11.24 Draft for council and community review
 21.02.25 Council and community review

LEGEND

- Title boundary / cadastre
- Pre development contours at 200mm intervals
- Extent of works
- Existing speed limit
- Proposed speed limit
- Tree to be protected & retained
- Existing footpath
- Existing grass swale
- Existing overhead power line & power pole
- Tree to be removed
- Item to be removed / demolished
- Existing driveway crossover
- Proposed asphalt surface
- Proposed concrete footpath / surface
- Proposed gravel footpath
- Grass naturestrip
- Proposed garden bed
- Proposed kerb
- Proposed car park
- Proposed long vehicle park
- Proposed loading zone
- Proposed large canopy tree
- Proposed small tree
- Traffic direction
- Proposed finger board sign
- Proposed interpretive signage
- Bus stop
- Bus stop upgrade
- Proposed bus shelter
- Proposed furniture node

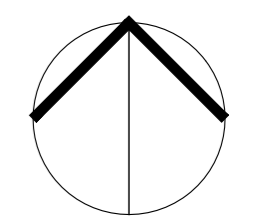

Project Name & Address:
**Northern Streetscapes
 SCARSDALE**

Drawing Title:
**Overall Concept Plan &
 Planting Palette**

Client:
Golden Plains Shire Council

Date: February 21, 2025
 Scale: 1:500 @ A1 Sheet Size

Drawn: OJ

Checked: HM

Drawing No: 2433 - LP07

Revision:

THOMSON HAY
 LANDSCAPE ARCHITECTS

130 Howards Rd, Wattle Flat VIC 3352
 T 03 5334 5321 W www.thomsonhay.com

Base information derived from the following sources:

- Feature and level survey by LandSurveys
- Nemap aerial (December 21, 2024)
- GIS data sourced from open source data

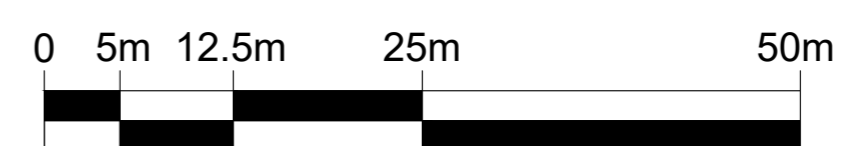

SCALE: 1:500

SCARSDALE CAR PARKING	Existing *	Proposed
Regular	0	9
Accessible Parking	0	0
Long Parking	0	2

*Formal car parking counted only.

SCARSDALE STREETSCAPE

KEY RECOMMENDATIONS

Thank you for your input into the community consultation for the streetscape upgrade works identified for Scarsdale in December 2024. Our design team have listened to your input and finalised the concept plan for your final review. Please share your thoughts in relation to the plans.

FUTURE STAGE WORKS DENOTED IN BLUE.

PUBLIC TRANSPORT & PARKING

- A. Realign bus stop (south) and kerb to minimise conflict between bus movements and south bound slip lane. Proposed 'Urban' bus stop shelter. Bus stop & shelter upgrades by Department of Transport & Planning.
- B. Formalise car parking including asphalt pavement, line marking and signage. Provide a loading zone.
- C. Option to formalise long vehicle parking on the north bound lane of Glenelg Highway and on south bound lane of Piffeld - Scarsdale Road.

STREET TREES & SOFT LANDSCAPING

- D. Large canopy clear trunk trees are proposed within the wide naturestrips to create an attractive green entrance to the town. Ensure tree species and location meets Department of Transport and Planning and Powercor guidelines (overhead powerlines). Replace existing Pittosporums with large canopy trees.
- E. Small canopy trees are proposed under powerlines on the south side of Browns-Scarsdale Road.
- F. Proposed garden bed planting within traffic island with granitic sand strip for ease of maintenance. Use hardy low growing shrubs, groundcovers, bladed plants and grasses to reduce ongoing maintenance and watering requirements. Garden bed planting to be less than 1.0m high for driver sightlines.

PEDESTRIAN ACCESS & SAFETY

- G. Upgrade pedestrian crossing on Browns - Scarsdale Road with kerb outstand, pram crossings and signage.
- H. New concrete path / pavement from bus stop (south) to Browns - Scarsdale Road. **Construct gravel foot path from Bus Stop to cemetery (Future Stage).**

STREET FURNITURE

- I. Street furniture including new furniture and replacements (bike racks, seats, community notice board and bins).

SIGNAGE

- J. Proposed oversized fingerboard sign with names and distances to smaller townships, destinations and local features, including the Ballarat Skipton Rail Trail.
- K. Community notice board and Aboriginal interpretive / narrative signage. Themes may relate to night sky on one side.

ROAD CLOSURE

- L. **Proposed closure of Glenelg Highway slip lane south of Browns-Scarsdale Road subject to approval of Department of Transport and Planning. This will significantly reduce traffic speed in the slip lane, and make it safer and easier for vehicles on Browns-Scarsdale Road to turn onto Glenelg Highway. It will also prevent the current practice of vehicles using the slip lane to enter the Glenelg Highway (going the wrong direction). The closed off slip lane and traffic island will be turned into a green space with grass and large canopy trees. Existing foot path to be retained.**

NOTES

- Negotiate with Department of Transport and Planning to re-do line marking on Glenelg Highway.
- Car parking numbers to be confirmed.
- Plant species selection to highlight township theme / character. Each township to have distinctive / different planting to reinforce identity. Native and indigenous understorey plants are included in the planting palette as a link to Wadawurrung Country.
- Plant selection subject to finalisation and availability.
- Speed limit reduction to 50kph, pending Department of Transport and Planning approval.

LEGEND

- Title boundary / cadastre
- Pre development contours at 200mm intervals
- Existing speed limit
- Proposed speed limit
- Tree to be protected & retained
- Existing footpath
- Existing grass swale
- Existing overhead power line & power pole
- Tree to be removed
- Item to be removed / demolished
- Existing driveway crossover
- Proposed asphalt surface
- Proposed concrete footpath / surface
- Proposed gravel footpath
- Grass naturestrip
- Proposed garden bed
- Proposed kerb
- Proposed car park
- Proposed long vehicle park
- Proposed loading zone
- Proposed large canopy tree
- Proposed small tree
- Traffic direction
- Proposed finger board sign
- Proposed interpretive signage
- Bus stop
- Bus stop upgrade
- Proposed bus shelter
- Proposed furniture node
- Proposed community notice board

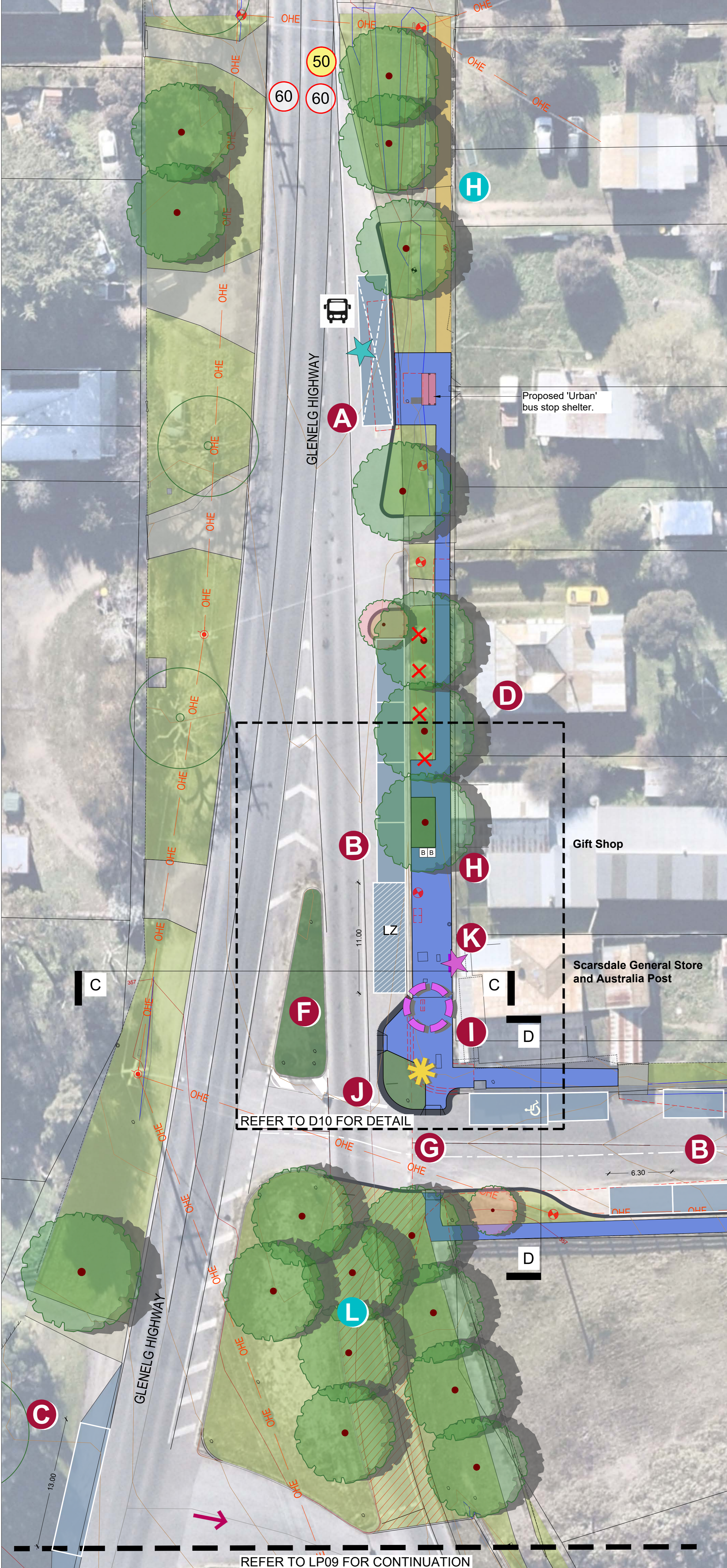

REFER TO D10 FOR DETAIL

REFER TO LP09 FOR CONTINUATION

Project Name & Address:
**Northern Streetscapes
 SCARSDALE**

Drawing Title:
**Streetscape Concept Plan
 - Sheet 1**

Client:
Golden Plains Shire Council

Date: February 21, 2025

Scale: 1:200 @ A1 Sheet Size

Drawn: OJ

Checked: HM

Drawing No: 2433 - LP08

Revision:

THOMSON HAY
 LANDSCAPE ARCHITECTS

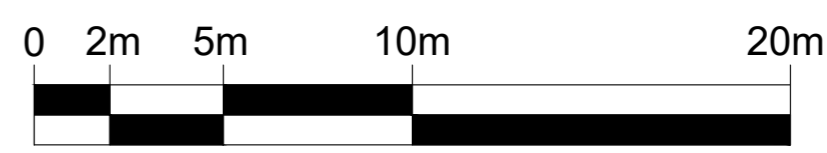
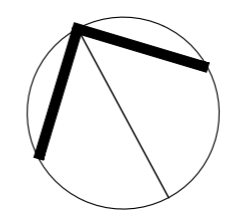

SCALE: 1:200

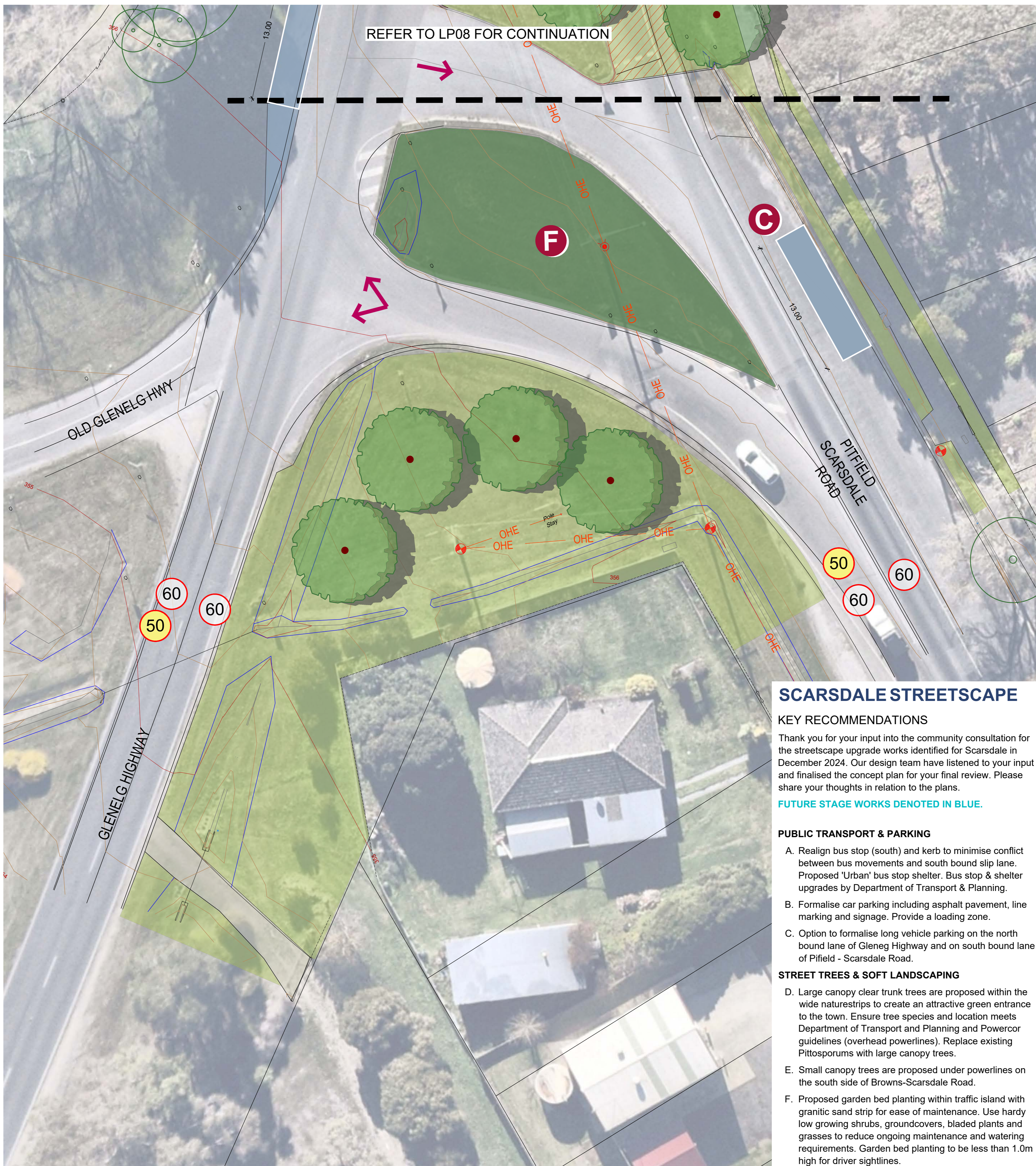

LEGEND

- Title boundary / cadastre
- Pre development contours at 200mm intervals
- Existing speed limit
- Proposed speed limit
- Tree to be protected & retained
- Existing footpath
- Existing grass swale
- Existing overhead power line & power pole
- Existing driveway crossover
- Proposed asphalt surface
- Grass naturestrip
- Proposed garden bed
- Proposed long vehicle park
- Proposed large canopy tree
- Traffic direction

SCARSDALE STREETSCAPE

KEY RECOMMENDATIONS

Thank you for your input into the community consultation for the streetscape upgrade works identified for Scarsdale in December 2024. Our design team have listened to your input and finalised the concept plan for your final review. Please share your thoughts in relation to the plans.

FUTURE STAGE WORKS DENOTED IN BLUE.

PUBLIC TRANSPORT & PARKING

- A. Realign bus stop (south) and kerb to minimise conflict between bus movements and south bound slip lane. Proposed 'Urban' bus stop shelter. Bus stop & shelter upgrades by Department of Transport & Planning.
- B. Formalise car parking including asphalt pavement, line marking and signage. Provide a loading zone.
- C. Option to formalise long vehicle parking on the north bound lane of Glenelg Highway and on south bound lane of Pitfield - Scarsdale Road.

STREET TREES & SOFT LANDSCAPING

- D. Large canopy clear trunk trees are proposed within the wide naturestrips to create an attractive green entrance to the town. Ensure tree species and location meets Department of Transport and Planning and Powercor guidelines (overhead powerlines). Replace existing Pittosporums with large canopy trees.
- E. Small canopy trees are proposed under powerlines on the south side of Browns-Scarsdale Road.
- F. Proposed garden bed planting within traffic island with granitic sand strip for ease of maintenance. Use hardy low growing shrubs, groundcovers, bladed plants and grasses to reduce ongoing maintenance and watering requirements. Garden bed planting to be less than 1.0m high for driver sightlines.

PEDESTRIAN ACCESS & SAFETY

- G. Upgrade pedestrian crossing on Browns - Scarsdale Road with kerb outstand, pram crossings and signage.
- H. New concrete path / pavement from bus stop (south) to Browns - Scarsdale Road. Construct gravel foot path from Bus Stop to cemetery (Future Stage).

STREET FURNITURE

- I. Street furniture including new furniture and replacements (bike racks, seats, community notice board and bins).

SIGNAGE

- J. Proposed oversized fingerboard sign with names and distances to smaller townships, destinations and local features, including the Ballarat Skipton Rail Trail.
- K. Community notice board and Aboriginal interpretive / narrative signage. Themes may relate to night sky on one side.

ROAD CLOSURE

- L. Proposed closure of Glenelg Highway slip lane south of Browns-Scarsdale Road subject to approval of Department of Transport and Planning. This will significantly reduce traffic speed in the slip lane, and make it safer and easier for vehicles on Browns-Scarsdale Road to turn onto Glenelg Highway. It will also prevent the current practice of vehicles using the slip lane to enter the Glenelg Highway (going the wrong direction). The closed off slip lane and traffic island will be turned into a green space with grass and large canopy trees. Existing foot path to be retained.

NOTES

- Negotiate with Department of Transport and Planning to re-do line marking on Glenelg Highway.
- Car parking numbers to be confirmed.
- Plant species selection to highlight township theme / character. Each township to have distinctive / different planting to reinforce identity. Native and indigenous understorey plants are included in the planting palette as a link to Wadawurrung Country.
- Plant selection subject to finalisation and availability.
- Speed limit reduction to 50kph, pending Department of Transport and Planning approval.

Project Name & Address:
 Northern Streetscapes
 SCARSDALE

Drawing Title:
 Streetscape Concept Plan
 - Sheet 2

Client:
 Golden Plains Shire Council

Date: February 21, 2025
Scale: 1:200 @ A1 Sheet Size
Drawn: OJ
Checked: HM
Drawing No: 2433 - LP09

Revision:

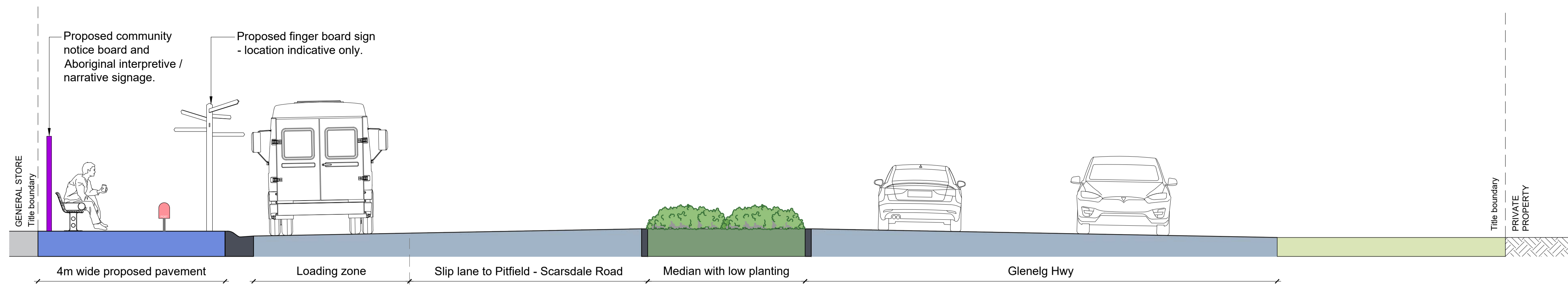

PROPOSED SECTION C-C
 Scale 1:50 @ A1

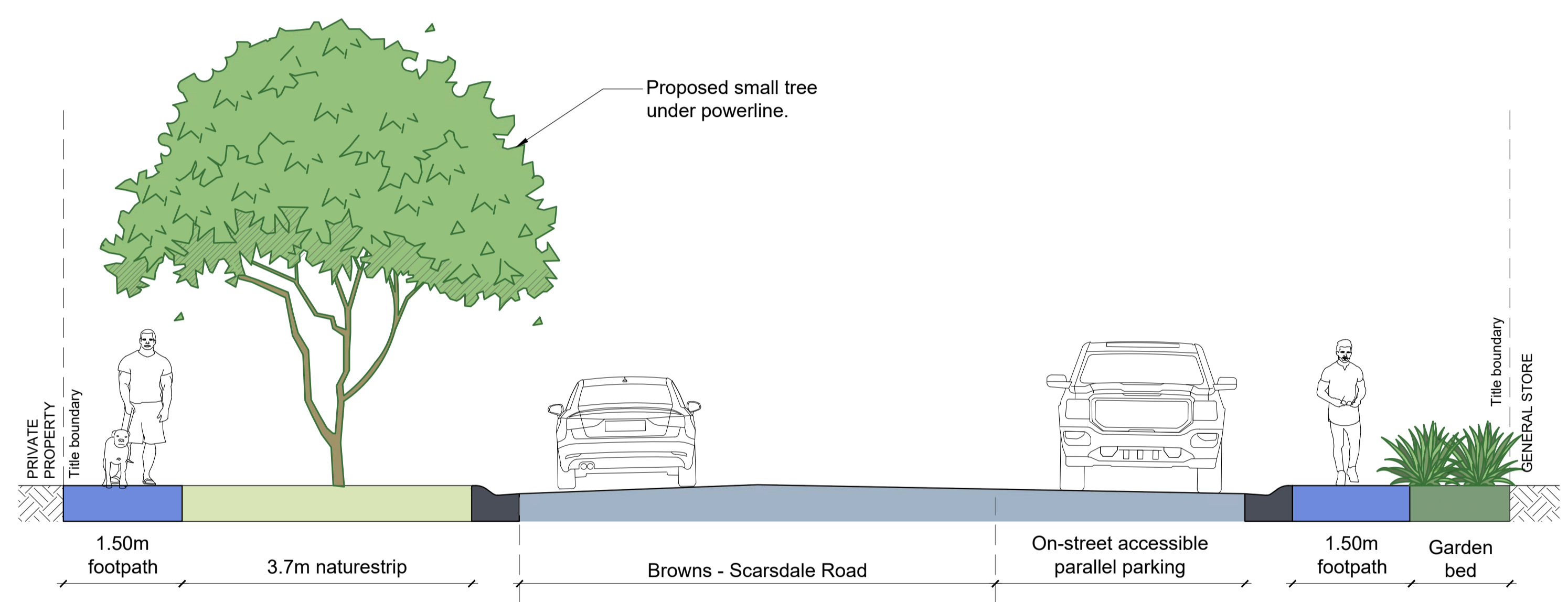

PROPOSED SECTION D-D
 Scale 1:50 @ A1

- LEGEND**
- Pre development contours at 200mm intervals
 - Tree to be removed
 - Item to be removed / demolished
 - Proposed asphalt surface
 - Proposed concrete footpath / surface
 - Grass naturestrip
 - Proposed garden bed
 - Proposed kerb
 - Proposed car park
 - Proposed long vehicle park
 - Proposed loading zone
 - Proposed large canopy tree
 - Proposed finger board sign
 - Proposed seat
 - Proposed bike rack
 - Proposed community notice board & interpretive signage
 - Proposed bin location

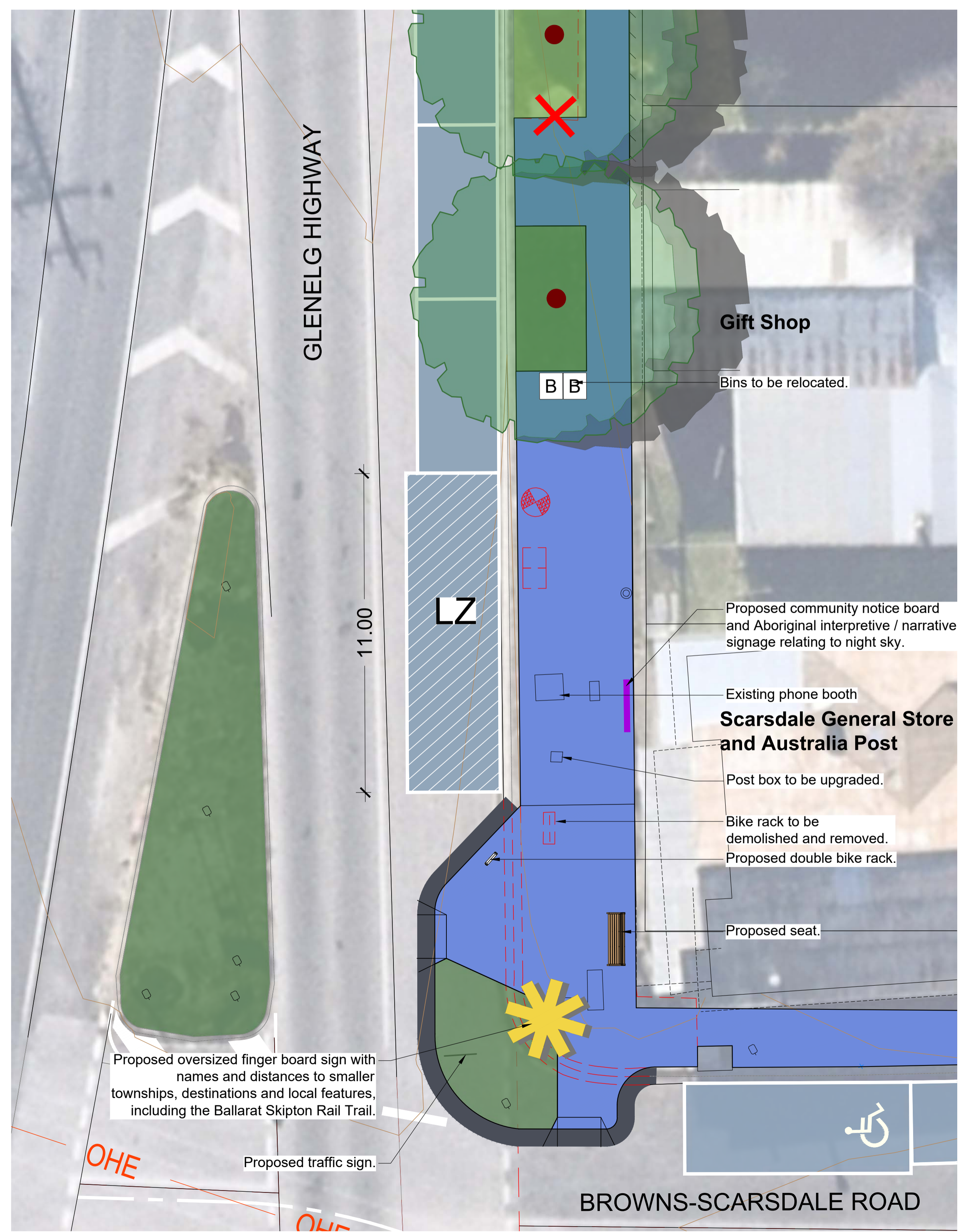

DETAIL PLAN
 Scale 1:100 @ A1

Project Name & Address:
**Northern Streetscapes
 SCARSDALE**

Drawing Title:
**Streetscape Concept
 Sections & Detail Plan**

Client:
Golden Plains Shire Council

Date: February 21, 2025
 Scale: 1:50 @ A1 Sheet Size

Drawn: OJ
 Checked: HM

Drawing No: 2433 - LP10

Revision:

THOMSON HAY
 LANDSCAPE ARCHITECTS