



Change how you use your bins from February 2025

Waste and recycling systems are changing so more can be made from the resources in our kerbside bins.

You have received this new glass bin as part of the service changes. This guide gives you an overview of the changes.

Glass bottles and jars will be collected separately from mixed recycling in your new purple bin.

Changes to how often your bin is collected

Your glass recycling will be collected every four weeks on your regular collection day, starting the week of 17 February 2025. **Please begin using your new glass bin in January 2025** following the instructions outlined in this guide.

Your mixed recycling bin will be collected fortnightly on your regular collection day from the week commencing 3 February 2025.

Your general waste bin will continue to be collected fortnightly on your regular collection day from the week commencing 27 January 2025.

Please check the waste collection calendar (included in this pack) or visit goldenplains.vic.gov.au for more information.

Make sure the lids on all your bins can close to prevent litter.

Bin size and lid colour

In Golden Plains Shire:

- Your glass bin is 140L.
- Your mixed recycling bin is 240L.
- Your general waste bin is 240L. Some properties may have a dark green or maroon lid for their general waste bin. These bins remain approved for use.

If the standard bin sizes don't meet your needs, you can apply for additional bin services from Council (costs apply).

Your small acts make a big impact

This shift is part of Victoria's transition to a consistent four-stream recycling system under the Circular Economy (Waste Reduction and Recycling) Act 2021.

By sorting your waste properly, **you're helping to reduce material going to landfill** and ensure that glass bottles and jars can be recycled indefinitely.

Our new interactive sorting guide powered by Recycle Mate™ is now available on our website. You can also download the Recycle Mate™ app on your smart device.



More information

If you have any questions about the upcoming changes, visit our website: goldenplains.vic.gov.au

Or contact us:

Golden Plains Shire Council

email: enquiries@gplains.vic.gov.au

Phone: 5220 7111



From February 2025, the way we recycle is changing for the better

A small act makes a big impact



What goes in each bin

For a full list visit goldenplains.vic.gov.au

Learn the right way to recycle with Recycle Mate™. Scan the QR code to search over 7,500 everyday items. Check what can go in your bins or which items can be dropped off at waste transfer stations, local stores or donated to local charities.



Glass recycling

Put lightly rinsed, empty glass bottles and jars loose, not in bags.

Lids and bottle caps must be removed, check the mixed recycling section for instructions on how to dispose of these items.

✓ Yes



Glass bottles including beer, wine and olive oil bottles

Glass jars including pasta sauce and condiment jars



Glass bottles and jars for medicine or toiletries

⊘ No



Ceramics, drinking glasses and glass cookware



Material in any type of bag

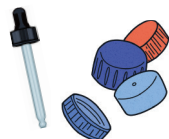

Lids, pumps, sprays and droppers



Light bulbs

Mixed recycling

Put your recycling loose, not in bags.

Flatten cardboard boxes to save space.

Plastic lids to remain on plastic bottles and containers in the mixed recycling bin.

✓ Yes



Empty hard plastic containers

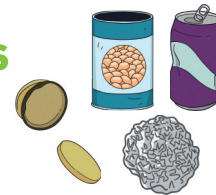

Empty tins and cans, metal lids, foil



Clean cardboard, paper and drink cartons

⊘ No



Material in any type of bag



Textiles and shoes

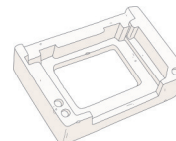

Polystyrene

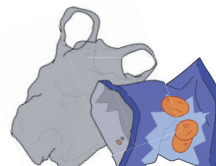

Soft plastics



Coffee cups and coated cardboard

General waste

Use this bin only for items that can't be reused or recycled. Please bag your waste.

✓ Yes



Nappies, wet wipes, animal poo

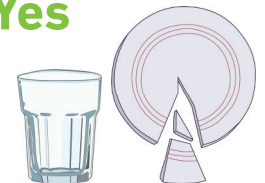

Ceramics, drinking glasses and glass cookware

Food scraps and garden waste if you don't compost



Textiles and shoes



Pumps, sprays, droppers and plastic lids from glass jars and drink cartons

Not in any bin

⊘ No



Household chemicals



Electronic waste and batteries

Construction waste and soil

